

Analog transmitter

ATD-2



Operation

A Hall-sensor detects the position of the magnet float and provides an analog signal.

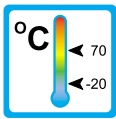

Application

The analog transmitter type ATD-2 can be used in combination with various flowmeters (see table page 2).

They produce an appropriate signal for the respective flow. The signal can be employed by the user for most different measuring applications and tasks of regulation.

Areas of application:

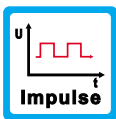
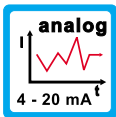

– Coolingsystems and cooling circuits

– Medicine technology

– Pharmaceutical industry

– Chemical industry

– Research and development

Features

The ATD-2 series proves itself through reliable function and high repeatability.

The analog transmitters ATD-2 are bolted to the chosen flowmeter ex works, where also the analog output is adjusted to the according measuring range.

Further characteristics of this series are:

– Currency- or voltage output (4 - 20 mA / 0 - 10 V)

– Optional: Switch- or frequency output

– High temperature range

– Full metal version

Installation hints

The analog transmitter type ATD-2 must be used only in combination with the flowmeters indicated on page 2 (table). The electronics cannot be mounted to any other flowmeter without adjustment at Meister Strömungstechnik GmbH.

The operating instruction for ATD-2 must be observed under any circumstances!

ATD-2 1 0001 04-05 E M



Technical data

Dimensions

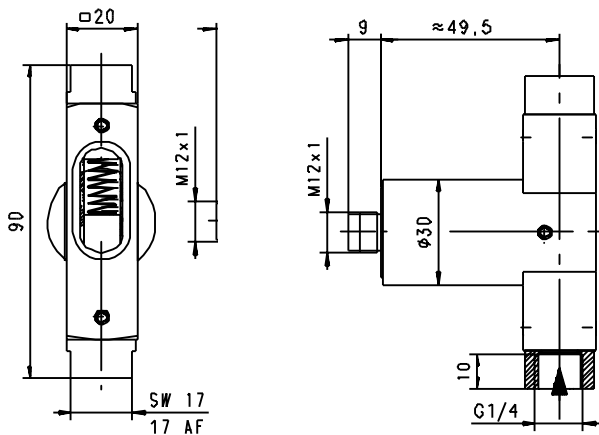

ATD-2 on RVO/U-4

Connection diagram

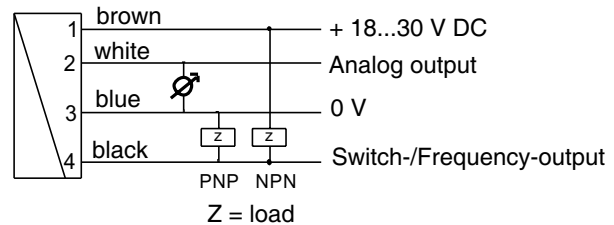

Technical data	
Measuring range:	depends on used flowmeter (see table below)
Accuracy:	± 3 % f.s.d.
Repeatability:	1 % f.s.d.
Operating temperature:	-20 °C...+70 °C
Storage temperature:	-20 °C...+80 °C
Operating voltage:	18...30 VDC
Power consumption:	< 1 W
Analog output:	4 - 20 mA or 0 - 10 V
Limit value switch:	electronic programmable Min.- or Max.-Switch, max. 100 mA, short circuit proof, free from polarization errors
Hysteresis (electronic):	
by Min.-Switch	2 % f.s.d. beyond the limit value
by Max.-Switch	2 % f.s.d. beneath the limit value
Hysteresis (mechanic): depends on flowmeter	
Indication (Switch output only): LED (on = ok / off = alarm)	
Body material: Stainless Steel 1.4305	
Connection: for round plug M12 x 1, 4pol	
Ingress protection: IP 67	

Combination options

Flowmeter		Flowmeter		Flowmeter		Flowmeter	
DKG-1	▼	DUG-4 to DUG-45	▼	DWG-1,5 to DWG-18	▼	RVO/U-1	▼
DKG-2	▼	DUG-70 to DUG-250	▼	DWG-35 to DWG-150	▼	RVO/U-2	▼
DKM-1	▼	DUM-4 to DUM-55	▲	DWG-L1,5 to DWG-L18	▼	RVO/U-4	▲
DKM-2	▼	DUM-70 to DUM-250	▼	DWG-L35 to DWG-L100	▼	RVO/U-L1	▼
DKM/A	▼	DUM/A-4 to DUM/A-55	▼	DWM-1,5 to DWM-18	▲	RVO/U-L2	▼
DKME	▼	DUM/A-70 to DUM/A-250	▼	DWM-35 to DWM-150	▼	RVO/U-L4	▲
DKME/A	▼			DWM-L1,5 to DWM-L18	▲	RVM/U-1	▼
				DWM-L50 to DWM-L100	▼	RVM/U-2	▼
				DWM/A-1,5 to DWM/A-18	▼	RVM/U-4	▲
				DWM/A-35 to DWM/A-150	▼	RVM/U-L1	▼
				DWM/A-L1,5 to DWM/A-L18	▼	RVM/U-L2	▼
				DWM/A-L50 to DWM/A-L100	▼	RVM/U-L4	▲

▲ Combination possible ▼ Combination on request